



12 June 2026

Greg Higginbotham, County Administrator
Madison County, Mississippi
125 West North Street, Canton, MS 39046
greg.higginbotham@madison-co.com

PAUL J. BAGLEY, AIA, LEED AP
A. BRUCE WOOD, AIA
RANDALL A. LEWIS, AIA, CSI
BENJAMIN A. HALL, LEED AP
BEN R. KITCHENS, AIA, LEED AP
ADAM R. HAVER, CSI
TAYLOR STEWART, CSI

**Re: Proposed Change Requests
Madison County Mississippi Circuit Court Building
Renovation & Addition
JH&H No.: 23-132**

Mr. Higginbotham:

Below are several change requests developed by the Contractor due to various conditions as indicated below with description and proposed cost to be deducted from the contingency allowance.

PCO No. 006: Temporary Space in Courthouse B Supplemental HVAC and application of tint on glazing. \$28,753.00.

This PCO was developed at the request of the County in response to the heat gain experienced in the lobby space to assist in cooling the space for the comfort of occupants. We find the cost for this change reasonable.

PCO No. 007: Partial concrete slab replacement. \$12,350.00.

A portion of the existing Circuit Court Building slab was not flat but due to the layout of rooms in the area, largely went unnoticed. We discovered this during the renovation design and noted the area to be ground and leveled to achieve the required flatness necessary for the new floor finishes. The Contractor stated the work to achieve the desired flatness would exceed the requirements of the documents. Since they have money in the project for the work described, the Contractor is applying it to the total cost of the work to correct existing conditions.

The Contractor is planning to demolish the slab and walls in the noted areas at their cost and requesting the County pay for the new concrete slab installation. The total cost of the change is \$30,228.81 with Sullivan Enterprises paying \$17,878.81 out of money already in their bid price. This leaves the County's cost at \$12,350.00. We have reviewed the cost and find it fair and reasonable.

PCO No. 009: Unsuitable fill material removal and replacement. \$61,053.75.

During the process of developing the east addition building pad, several soft spots were discovered. Under the Testing Lab's direction, the Contractor was required to excavate the unclassified material containing old building debris (bricks, concrete, etc.), organics, and trash/rubbish, and replace with suitable fill material. The cost is determined from the unit cost Sullivan Enterprises provided on bid day with documentation indicating the quantity of dirt removed from the site. We find the cost reasonable.

JH&H Architects Planners Interiors
A Professional Association

1047 N Flowood Drive
Flowood, MS 39232

o 601.948.4601

f 601.355.6200

e jhh@jhharchitects.com

w jhharchitects.com

PCO No. 010: Door Frame 111 replacement. \$2,142.00

An existing door frame indicated to be reused in the contract documents is not suitable for reuse and requires replacement. The cost provided is fair and reasonable.

The above amounts total as indicated below.

PCO 006	Temporary Space in Courthouse B Supplemental HVAC and application of tint on glazing	\$28,753.00
PCO 007	Partial concrete slab replacement	\$12,350.00
PCO 009	Unsuitable fill material removal and replacement	\$61,053.75
PCO 010	Door Frame 111 replacement	\$2,142.00
Subtotal		\$104,298.75

If you have any questions concerning any of the items above or need more information, please feel free to contact me.

Sincerely,

JH&H Architects | Planners | Interiors PA



Joshua Jeffcoat, NCARB
Senior Architect

G:\23132 Madison County Circuit
Court\Const_Admin\Change_Orders\23132_COs_20260612.docx

JH&H Architects Planners Interiors
A Professional Association

1047 N Flowood Drive
Flowood, MS 39232

o 601.948.4601

f 601.355.6200

e jhh@jhharchitects.com

w jhharchitects.com



June 1, 2026

Mr. Joshua Jeffcoat
JH&H Architects/Planners/Interiors, PA
1047 North Flowood Drive
Flowood, Mississippi 39232

Re.: PN: 23132 Madison County Mississippi Circuit Court Building Renovations and Addition | PCO 006r

Dear Joshua:

The following is the proposed change order price to provide all labor and materials necessary to install a Daikin 4 ton VRV-S heat pump condenser with Two 2 ton cassettes.

A&B Mechanical, Inc.	\$18,680.00
Shivers Electrical	\$4,800.00
Ceiling Demolition	\$500.00
Ceiling Grid Rework	\$500.00
Ceiling Tile Installation	\$450.00
Window Film Option 1	\$3,823.00
Window Film Option 2	\$3,823.00
Window Film Option 3	\$3,737.00
Total Change to Contract Sum Using Allowances (Using Window Film Option 1 or 2)	\$28,753.00
Total Change to Contract Sum Using Allowances (Using Window Film Option 3)	\$28,667.00

Thanks,

Sage Mullins

Sullivan Enterprises, Inc.

A&B Mechanical, Inc.

307 Walker Circle bld A
Richland, Ms 39218
brian@aandbmechanical.com
662-418-2186

April 28, 2026

Madison County Temporary Circuit Court Lobby Unit

Below are Two quotes where we will provide labor, equipment and materials to install:

Option A

Daikin 4 ton VRV-S heat pump condenser with one 4 ton cassette

Option B

Daikin 4 ton VRV-S heat pump condenser with Two 2 ton cassettes

Both options are for the front lobby area of the temporary Circuit Court in Madison County. The condenser will be placed on an existing roof curb, with a custom curb cap. We will add 2 layers of 2 inch thick foam board to insulate the lobby from unit noise.

	Option A	Option B
Equipment	\$7,250.00	\$8,380.00
Material	\$3,600.00	\$3,600.00
Labor	\$3,000.00	\$3,600.00
Mark-up	\$2,770.00	\$3,100.00
A&B Total	\$16,620.00	\$18,680.00
Shivers Electric	\$3,880.00	\$4,800.00
Total	\$20,500.00	\$23,480.00

Regards,

Brian Hazelwood
Owner & President
A&B Mechanical, Inc.



SHIVERS CONSTRUCTION CO., LLC

Electrical Contractors

901 S. WEST STREET
P.O. BOX 22605
JACKSON, MS 39225
601-968-0145
601-968-0144 fax

Project: Madison County Court House

Re: PCO for A/C units Temp Building

Attn: Richie Ray (A&B Mechanical)

Proposed Change Scope:

This price is to provide a turnkey installation for the above-mentioned systems. The Price provided includes the following.

This price is for the single head unit:

Material: \$660.00
Labor: \$2,580.00
Mark-Up: \$640.00
Total: \$3,880.00

This price is for the double head unit:

Material: \$900.00
Labor: \$3,100.00
Mark-Up: \$800.00
Total: \$4,800.00

CR #16433

Thank you for the opportunity to provide this quote!

PRICE GOOD FOR THIRTY DAYS.

David Bearden

Project Manager/Member

Shivers Construction Co., LLC.

PH: (601)968-0145



291 US-51
Suite E4
Ridgeland, MS 39157

Office: 601-707-5596
www.MGTfilms.com

Proposal		
Tue	5/26/2026	6:00AM



Job ID 5398 Cust # 4013
Sullivan Enterprises Inc.
Sage Mullen
PO Box 859
Magee, MS 39111

Work: 662-832-2304
Email: sage@sullivanent.net

Site Canton Court House Sage Mullin, 229 S. Union St., Canton, MS Work: 662-832-2304 Email: sage@sullivanent.net

Option 1: DUAL REFLECTIVE COOLOPTITUNE SERIES 515203040 AVERY

Area	# of Panels	Amount
2 entrances - doors	8	
2 entrances - side lights	18	
2 entrances - transoms	4	
4 panel windows	36	
Circuit Clerk doors	2	
Drive up window	1	
Section 1 Total	69	3,823.00
Subtotal		3,823.00
Total:	69	\$3,823.00

Option 2: DUAL REFLECTIVE WARMOPTISHADE 25 AVERY

Area	# of Panels	Amount
2 entrances - doors	8	
2 entrances - side lights	18	
2 entrances - transoms	4	
4 panel windows	36	
Circuit Clerk doors	2	
Drive up window	1	
Section 2 Total	69	3,823.00
Subtotal		3,823.00
Total:	69	\$3,823.00

Option 3: NEUTRALNATURA 30 AVERY

Area	# of Panels	Amount
2 entrances - doors	8	
2 entrances - side lights	18	
2 entrances - transoms	4	
4 panel windows	36	
Circuit Clerk doors	2	
Drive up window	1	
Section 3 Total	69	3,737.00
Subtotal		3,737.00
Total:	69	\$3,737.00

Salesperson: Cindy Tauchar - 6017200717
Quote good until: 6/25/2026
Payment Terms: Upon Receipt/COD

Standard general liability and worker's comp insurance included in the price. Customer responsible for cost of additional coverage if required.

Guarantee: All materials and workmanship are guaranteed to be as specified and the work to be performed in accordance with this written proposal, completed in a workman like manner for the amount indicated. Any change(s) from these specifications requiring extra time, labor or materials will result in additional charges to the amount indicated above. You, the buyer, may cancel this transaction at any time prior to midnight of the third business day after the date of this transaction. Our company is not responsible for glass breakage due to improper glass installation, existing glass damage or scoring from previous film installation. Interest at the rate of 1 1/2 percent per month will be charged on past due invoices.

50% deposit required upon acceptance.

Please note that a trip charge will be charged if job sections are done separately.

If job site is not ready, or customer is not available for install after confirming appointment, a second mobilization charge will be charged.

Photography and Videography Consent. Client acknowledges and agrees that Company may photograph and/or video-record the project site, work in progress, and completed installation for business purposes, including, without limitation, marketing materials, social media, website content, promotional materials, portfolio displays, and internal training and quality control. Client grants Company a perpetual, royalty-free license to use such photographs and videos for these purposes. Client may opt out of this authorization by providing written notice to Company prior to commencement of work, and such opt-out will not affect the terms or pricing of this Agreement.

Acceptance of Proposal /Authorization to Work:

The above prices, specifications, terms and conditions are satisfactory to me and are hereby accepted. My signature authorizes you to do the work.

Date

Customer Signature

[E-Sign](#)

Authorized Dealer Signature

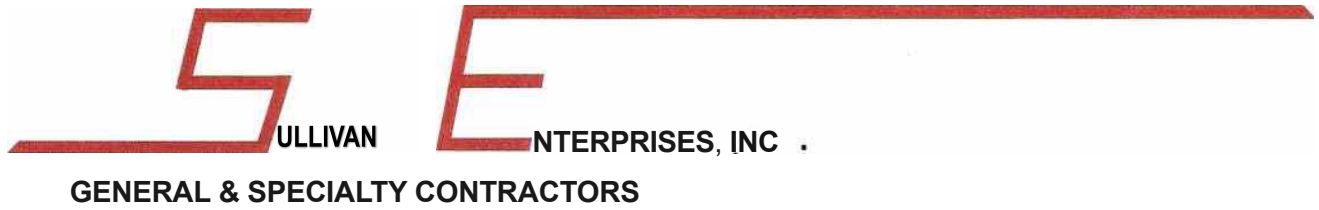

June 1, 2026

Mr. Joshua Jeffcoat
JH&H Architects/Planners/Interiors, PA
1047 North Flowood Drive
Flowood, Mississippi 39232

Re.: PN: 23132 Madison County Mississippi Circuit Court Building Renovations and Addition | PCO 006r

Dear Joshua:

The following is the proposed change order price to provide all labor and materials necessary to install a Daikin 4 ton VRV-S heat pump condenser with Two 2 ton cassettes.

A&B Mechanical, Inc.	\$18,680.00
Shivers Electrical	\$4,800.00
Ceiling Demolition	\$500.00
Ceiling Grid Rework	\$500.00
Ceiling Tile Installation	\$450.00
Window Film Option 1	\$3,823.00
Window Film Option 2	\$3,823.00
Window Film Option 3	\$3,737.00
Total Change to Contract Sum Using Allowances (Using Window Film Option 1 or 2)	\$28,753.00
Total Change to Contract Sum Using Allowances (Using Window Film Option 3)	\$28,667.00

Thanks,

Sage Mullins

Sullivan Enterprises, Inc.

A&B Mechanical, Inc.

307 Walker Circle bld A
Richland, Ms 39218
brian@aandbmechanical.com
662-418-2186

April 28, 2026

Madison County Temporary Circuit Court Lobby Unit

Below are Two quotes where we will provide labor, equipment and materials to install:

Option A

Daikin 4 ton VRV-S heat pump condenser with one 4 ton cassette

Option B

Daikin 4 ton VRV-S heat pump condenser with Two 2 ton cassettes

Both options are for the front lobby area of the temporary Circuit Court in Madison County. The condenser will be placed on an existing roof curb, with a custom curb cap. We will add 2 layers of 2 inch thick foam board to insulate the lobby from unit noise.

	Option A	Option B
Equipment	\$7,250.00	\$8,380.00
Material	\$3,600.00	\$3,600.00
Labor	\$3,000.00	\$3,600.00
Mark-up	\$2,770.00	\$3,100.00
A&B Total	\$16,620.00	\$18,680.00
Shivers Electric	\$3,880.00	\$4,800.00
Total	\$20,500.00	\$23,480.00

Regards,

Brian Hazelwood
Owner & President
A&B Mechanical, Inc.



SHIVERS CONSTRUCTION CO., LLC

Electrical Contractors

901 S. WEST STREET
P.O. BOX 22605
JACKSON, MS 39225
601-968-0145
601-968-0144 fax

Project: Madison County Court House

Re: PCO for A/C units Temp Building

Attn: Richie Ray (A&B Mechanical)

Proposed Change Scope:

This price is to provide a turnkey installation for the above-mentioned systems. The Price provided includes the following.

This price is for the single head unit:

Material: \$660.00
Labor: \$2,580.00
Mark-Up: \$640.00
Total: \$3,880.00

This price is for the double head unit:

Material: \$900.00
Labor: \$3,100.00
Mark-Up: \$800.00
Total: \$4,800.00

CR #16433

Thank you for the opportunity to provide this quote!

PRICE GOOD FOR THIRTY DAYS.

David Bearden

Project Manager/Member

Shivers Construction Co., LLC.

PH: (601)968-0145



291 US-51
Suite E4
Ridgeland, MS 39157

Office: 601-707-5596
www.MGTfilms.com

Proposal		
Tue	5/26/2026	6:00AM



Job ID 5398 Cust # 4013
Sullivan Enterprises Inc.
Sage Mullen
PO Box 859
Magee, MS 39111

Work: 662-832-2304
Email: sage@sullivanent.net

Site Canton Court House Sage Mullin, 229 S. Union St., Canton, MS Work: 662-832-2304 Email: sage@sullivanent.net

Option 1: DUAL REFLECTIVE COOLOPTITUNE SERIES 515203040 AVERY

Area	# of Panels	Amount
2 entrances - doors	8	
2 entrances - side lights	18	
2 entrances - transoms	4	
4 panel windows	36	
Circuit Clerk doors	2	
Drive up window	1	
Section 1 Total	69	3,823.00
Subtotal		3,823.00
Total:	69	\$3,823.00

Option 2: DUAL REFLECTIVE WARMOPTISHADE 25 AVERY

Area	# of Panels	Amount
2 entrances - doors	8	
2 entrances - side lights	18	
2 entrances - transoms	4	
4 panel windows	36	
Circuit Clerk doors	2	
Drive up window	1	
Section 2 Total	69	3,823.00
Subtotal		3,823.00
Total:	69	\$3,823.00

Option 3: NEUTRALNATURA 30 AVERY

Area	# of Panels	Amount
2 entrances - doors	8	
2 entrances - side lights	18	
2 entrances - transoms	4	
4 panel windows	36	
Circuit Clerk doors	2	
Drive up window	1	
Section 3 Total	69	3,737.00
Subtotal		3,737.00
Total:	69	\$3,737.00

Salesperson: Cindy Tauchar - 6017200717
Quote good until: 6/25/2026
Payment Terms: Upon Receipt/COD

Standard general liability and worker's comp insurance included in the price. Customer responsible for cost of additional coverage if required.

Guarantee: All materials and workmanship are guaranteed to be as specified and the work to be performed in accordance with this written proposal, completed in a workman like manner for the amount indicated. Any change(s) from these specifications requiring extra time, labor or materials will result in additional charges to the amount indicated above. You, the buyer, may cancel this transaction at any time prior to midnight of the third business day after the date of this transaction. Our company is not responsible for glass breakage due to improper glass installation, existing glass damage or scoring from previous film installation. Interest at the rate of 1 1/2 percent per month will be charged on past due invoices.

50% deposit required upon acceptance.

Please note that a trip charge will be charged if job sections are done separately.

If job site is not ready, or customer is not available for install after confirming appointment, a second mobilization charge will be charged.

Photography and Videography Consent. Client acknowledges and agrees that Company may photograph and/or video-record the project site, work in progress, and completed installation for business purposes, including, without limitation, marketing materials, social media, website content, promotional materials, portfolio displays, and internal training and quality control. Client grants Company a perpetual, royalty-free license to use such photographs and videos for these purposes. Client may opt out of this authorization by providing written notice to Company prior to commencement of work, and such opt-out will not affect the terms or pricing of this Agreement.

Acceptance of Proposal /Authorization to Work:

The above prices, specifications, terms and conditions are satisfactory to me and are hereby accepted. My signature authorizes you to do the work.

Date

Customer Signature

[E-Sign](#)

Authorized Dealer Signature



June 10, 2026

Mr. Joshua Jeffcoat
JH&H Architects/Planners/Interiors, PA
1047 North Flowood Drive
Flowood, Mississippi 39232

Re.: PN: 23132 Madison County Mississippi Circuit Court Building Renovations and Addition | PCO 007

Dear Joshua:

The following is the proposed change order price to provide all labor and materials necessary to demolish and replace the existing slab at Gallery #2. The original contract documents stated for this area to receive floor grinding and leveling to obtain a flat surface to receive new floor finishes. Once mobilized, elevations were taken and found that the proposed area ranges from 2"-5" higher than the remaining building. A meeting was held with Toby at Max Floors to review possible grinding in the proposed area. Toby stated that grinding is not possible to the depths required, and recommended that the existing slab be demolished and repoured. The proposed area of concrete to be demolished and repoured is 1,000 sf. Sullivan Enterprises, Inc. originally estimated \$12,000.00 for grinding and leveling. The proposed change order is a request for the additional cost to be covered by the contingency allowance.

Sullivan Enterprises, Inc.

Existing Wall Demolition	\$800.00
Existing Wall Disposal	\$800.00
Existing Slab Sawcutting	\$6,000.00
Existing Slab Demolition	\$1,200.00
Existing Slab Disposal	\$1,600.00
Reinstallation of Demolished Walls Following Slab Replacement	\$7,478.81
Sullivan to Cover Total	\$17,878.81

Madison County

Concrete Material	\$5,000.00
-------------------	------------

Concrete Misc. Materials (Vapor Barrier & Epoxy)	\$850.00
Concrete Reinforcements	\$1,000.00
Concrete Labor	\$5,500.00
Total Change to Contract Sum Using Allowances	\$12,350.00

Sullivan Enterprises, Inc. request 14 days to be added to the contract to complete the work.

Thanks,

Sage Mullins

Sullivan Enterprises, Inc.

Bid Summary

Madison Co. MS Circuit Court Bldg - Canton, MS

conference rm 102

Bid No. 25010

Selected Sections: 01602 Equipment Rental, 09110 Metal Studs, 09250 Drywall

Selected Typical Areas:

Selected Areas: (unassigned), PHASE 1, PHASE 2B, PHASE 2A, PHASE 3

Estimator:

Job Status:

Job Class:

Bid Date/Time: **7/10/2025 2:00:00 PM**

Wage Type: **Open**

Plans Date: **5/7/2025**

No.	Condition	Height	Quantity	Unit Cost			Total Cost	Man Days
				Mat.	Lab.	Total		
1	WT#1	16' 0"	44.92 LF	54.68	70.87	125.56 / LF	5,639.61	19.41
Material & Labor Subtotal:							5,639.61	19.41
			Quantity	Unit Cost			Total Cost	Man Days
				Equipment	Lab.	Total		
Equipment								
	19 foot lift		1.00	556.40	0.00	556.40	556.40	0.00
Equipment & Labor Subtotal:							556.40	0.00
Grand Subtotal:							6,196.01	19.41
10.00% Overhead							619.60	
9.73% Profit							663.20	
Grand without additional markups Total:							7,478.81	
Additional Markups Total:							0.00	
Grand Total:							7,478.81	

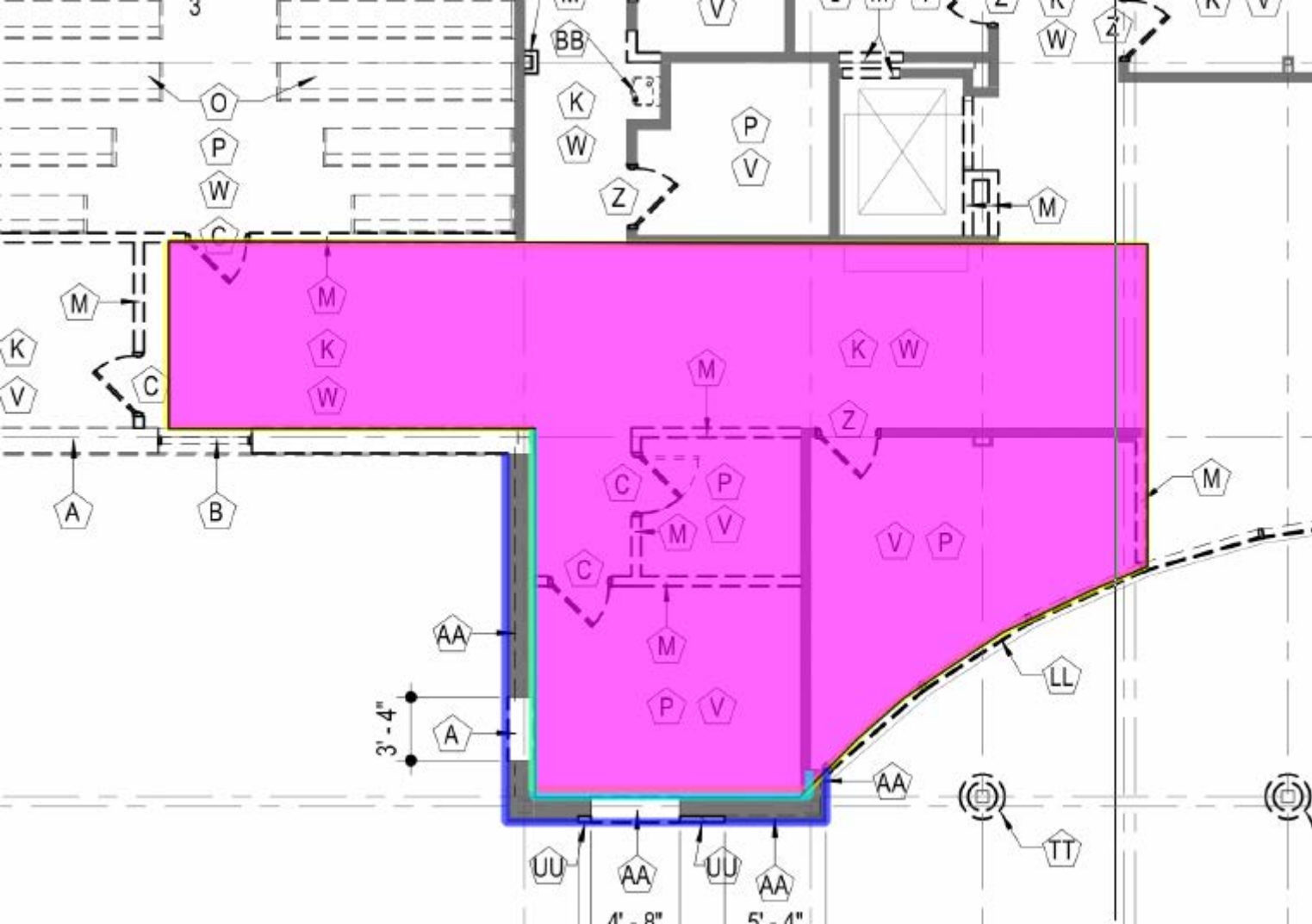



June 11, 2026

Mr. Joshua Jeffcoat
JH&H Architects/Planners/Interiors, PA
1047 North Flowood Drive
Flowood, Mississippi 39232

Re.: PN: 23132 Madison County Mississippi Circuit Court Building Renovations and Addition | PCO ~~006r~~ 009r

Dear Joshua:

The following is the proposed change order price for the undercut of unclassified soils under the East Addition. Per Ladner's recommendation existing unclassified soils were excavated to a depth of 6' below finish floor, and select fill was installed in lifts compacted to a minimum of 98%. The load count is the total of existing unclassified haul off. Project unit price for excavation, haul off and select fill is \$45/cy.

Unclassified Volume	2,025 cu/yds
Compaction at 33%	668.25 cu/yds
Total Volume	1,356.75 cu/yds
Project Unit Price	\$45.00/ cy
Total Change to Contract Sum Using Allowances	\$61,053.75

Sullivan Enterprises, Inc. request that 5 days be added to the contract to complete this work.

Thanks,
Sage Mullins
Sullivan Enterprises, Inc.



CLR Construction Group Inc.

1408 Victoria Lane

Brandon, MS 39042

COR: 25106-MC

psullivan@clrconstructiongroup.net

MADISON COUNTY COURTHOUSE HAULING REPORT

Description	CLR 01 "Joe"	CLR 02 "Al Garner"
Driver	Joe	Al
Trailer	25 yds	25 yds
Load Count	37	44
Volume Total	925 cu/yds	1100 cu/yds
TOTALS	Total Load Count: 81	Unclassified Volume Total: 2,025 cu/yds



June 10, 2026

Mr. Joshua Jeffcoat
JH&H Architects/Planners/Interiors, PA
1047 North Flowood Drive
Flowood, Mississippi 39232

Re.: PN: 23132 Madison County Mississippi Circuit Court Building Renovations and Addition | PCO 10

Dear Joshua:

The following is the proposed change order price to provide all labor and materials necessary to demo and install a new frame for opening 111.

Door Frame Material	\$1,142.00
Door Frame Install Labor	\$1,000.00
Total Change to Contract Sum Using Allowances	\$2,142.00

Thanks,
Sage Mullins
Sullivan Enterprises, Inc.

Bid Summary

Madison Co. MS Circuit Court Bldg - Canton, MS

Reframe around opening at room 111

Bid No. 25010

Selected Sections: 08100 Metal Doors and Frames, 09110 Metal Studs

Selected Typical Areas:

Selected Areas: (unassigned), PHASE 1, PHASE 2B, PHASE 2A, PHASE 3

Estimator:

Job Status:

Job Class:

Bid Date/Time: **7/10/2025 2:00:00 PM**

Wage Type: **Open**

Plans Date: **5/7/2025**

No.	Condition	Height	Quantity	Unit Cost			Total Cost	Man Days
				Mat.	Lab.	Total		
1	door 111	3' 4"	1.00 EA	49.20	794.88	844.08 / EA	844.08	4.06
Material & Labor Subtotal:							844.08	4.06
Grand Subtotal:							844.08	4.06
10.00% Overhead							84.41	
7.70% Profit							71.51	
Grand without additional markups Total:							1,000.00	
Additional Markups Total:							0.00	
Grand Total:							1,000.00	

